

XAL E-Campus

PHOTOGRAPHE
Kurt Kuball

ARCHITECTE
Designstudio zweithaler

SITE
Atriche



Produits utilisés



**BASO 60 IP54
surface**

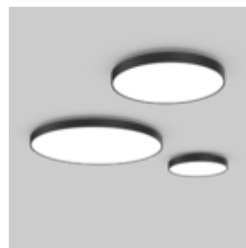

**VELA surface /
ceiling**



**SASSO 100 round
suspended**



BO 55 / 70 track

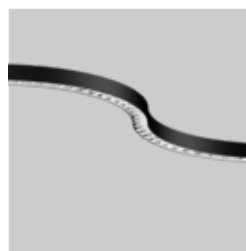

**BETO ceiling /
suspended system**



TULA suspended

XAL E-Campus

PHOTOGRAPHE
Kurt Kuball

ARCHITECTE
Designstudio zweithaler

SITE
Autriche

Images



XAL E-Campus

PHOTOGRAPHE
Kurt Kuball

ARCHITECTE
Designstudio zweithaler

SITE
Atriche



XAL E-Campus

PHOTOGRAPHE

Kurt Kuball

ARCHITECTE

Designstudio zweithaler

SITE

Autriche

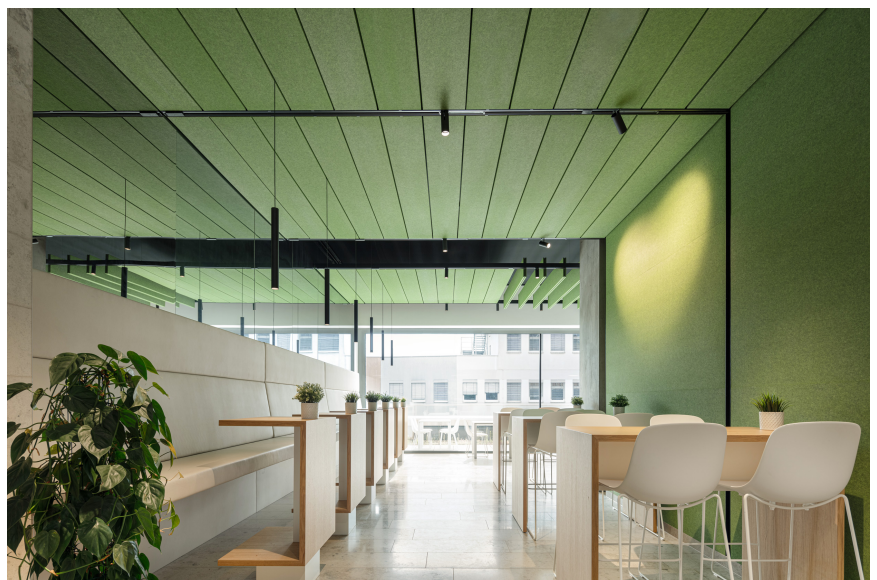

XAL E-Campus

PHOTOGRAPHE

Kurt Kuball

ARCHITECTE

Designstudio zweithaler

SITE

Autriche

