

# MOUNTING BRACKET

035-10200.25



Project / Type \_\_\_\_\_

Notes \_\_\_\_\_

Count / Date \_\_\_\_\_

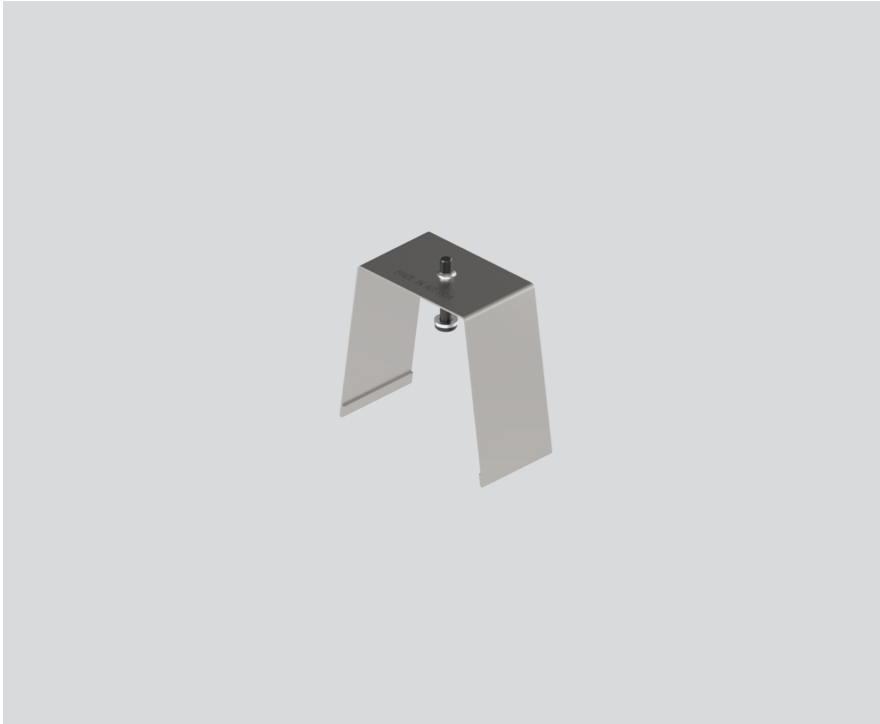

## General

25 pieces \_\_\_\_\_

## Physical

width 79 mm \_\_\_\_\_

1.96 kg \_\_\_\_\_

recessed trim \_\_\_\_\_

## Cutout

min. ceiling thickness 8 mm \_\_\_\_\_

max. ceiling thickness 25 mm \_\_\_\_\_