

TARO 32 downlight

MOVE IT 10 round

030-6740439S



Project / Type _____

Notes _____

Count / Date _____



Cylindrical spotlight in aluminium; surface anodised rose gold; light inset can be installed and moved without tools by means of clip mount; power supplied via MOVE IT system track profile; hot plug protection; passive cooling of the LEDs through improved heat sink geometry; light colour 2700 K; binning initial MacAdam ≤ 2 SDCM; CRI ≥ 90 ; min. 80% of luminous flux after 50000 operating hours; energy efficient LEDs with high CRI; good glare control through recessed light point level; precise radiation characteristic with 18° beam; no multiple shadows; optical attachment available as accessory; accessories are listed separately; degree of protection IP20; PC3; DALI-2 control; flicker-free visual comfort through analogue current control (minimum value 1%); light source replaceable by an authorized professional;

Light distribution

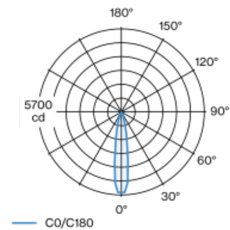

h (m)	E0° (lx)	ø (m)
1	5560	0.32
2	1390	0.63
3	620	0.95
4	350	1.27
5	220	1.58

Product drawing

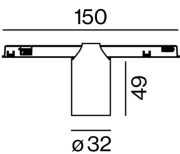

General

Ceiling / Wall , Track _____

rose gold _____

IP20 _____

734 lm _____

LED

2700 K _____

CRI ≥ 90 _____

L80 / 50000 h _____

initial MacAdam ≤ 2 SDCM _____

R_g: 99 , R_f: 91 , R_{1-15}: 89 _____

MR 0.53 _____

MDER 0.48 _____

Optical

spot _____

beam angle 18° _____

PstLM ≤ 1.0 ¹ _____

SVM ≤ 0.4 ¹ _____

Electrical

DALI-2 _____

system 9.6 W _____

PC3 _____

system 76 lm/W² _____

1 DALI Addr. _____

Physical

diameter 32 mm _____

height 60 mm _____

¹ Value of containing product at full load (undimmed)
² incl. optical losses and the efficiency of the operating device (converter)

Installation instructions

