

TARO 32 downlight

MOVE IT 10 round
030-6740633M



Project / Type

Notes

Count / Date



Cylindrical spotlight in aluminium; surface lacquered in brushed brass; light inset can be installed and moved without tools by means of clip mount; power supplied via MOVE IT system track profile; hot plug protection; passive cooling of the LEDs through improved heat sink geometry; light colour 4000 K; binning initial MacAdam ≤ 2 SDCM; CRI ≥ 90 ; min. 80% of luminous flux after 50000 operating hours; energy efficient LEDs with high CRI; good glare control through recessed light point level; precise radiation characteristic with 24° beam; no multiple shadows; optical attachment available as accessory; accessories are listed separately; degree of protection IP20; PC3; DALI-2 control; flicker-free visual comfort through analogue current control (minimum value 1%); light source replaceable by an authorized professional;



General

Ceiling / Wall , Track

brushed brass

IP20

859 lm

LED

4000 K

CRI ≥ 90

L80 / 50000 h

initial MacAdam ≤ 2 SDCM

R_g: 97 , R_f: 90 , R₍₁₋₁₅₎: 89

MR 0.81

MDER 0.74

Optical

medium

beam angle 24°

Electrical

DALI-2

9.6 W

PC3

89 lm/W

1 DALI Addr.

Physical

diameter 32 mm

height 60 mm

Light distribution



medium 24°

| h (m) | EO° (lx) | ø (m) |
|-------|----------|-------|
| 1 | 4570 | 0.42 |
| 2 | 1140 | 0.83 |
| 3 | 510 | 1.25 |
| 4 | 290 | 1.67 |
| 5 | 180 | 2.09 |

Product drawing

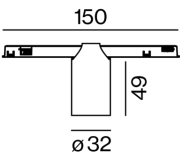

Installation instructions



TARO 32 downlight

MOVE IT 10 round
030-6740633M



Project / Type

Notes

Count / Date

Maintenance Factors

| Operating Time [h] | 10 000 | 20 000 | 30 000 | 40 000 | 50 000 |
|--------------------|--------|--------|--------|--------|--------|
| LLMF | 0.96 | 0.92 | 0.89 | 0.85 | 0.82 |
| LSF | 1 | 1 | 1 | 1 | 1 |

MF

MF

LMF^a

LMF × RSMF × LLMF × LSF

Maintenance Factor

Luminaire Maintenance Factor

RSMF^a

LLMF

LSF

Room Surface Maintenance Factor

Lamp Lumens Maintenance Factor

Lamp Survival Faktor

^a According to "CIE 97, Maintenance of indoor electric lighting systems", 2005, ISBN 3-900-734-34-8. The values must be determined by the planner.

Optical accessories

HONEYCOMB LOUVER

| | | |
|-----------|--------|-------------------|
| COLOUR | Ø (MM) | ARTICLE NUMBER(S) |
| jet black | 30 | 007-1965168 |



Optical accessories

OVAL LENS

| | |
|--------|-------------------|
| Ø (MM) | ARTICLE NUMBER(S) |
| 30 | 007-1965860 |



SOFT LENS

| | |
|--------|-------------------|
| Ø (MM) | ARTICLE NUMBER(S) |
| 30 | 007-1965960 |



WALLWASHER LENS

| | |
|--------|-------------------|
| Ø (MM) | ARTICLE NUMBER(S) |
| 30 | 007-1965760 |

