

TARO 32 downlight

MOVE IT 10 round
030-6740534M



Project / Type

Notes

Count / Date



Cylindrical spotlight in aluminium; surface polished chrome; light inset can be installed and moved without tools by means of clip mount; power supplied via MOVE IT system track profile; hot plug protection; passive cooling of the LEDs through improved heat sink geometry; light colour 3000 K; binning initial MacAdam ≤ 2 SDCM; CRI ≥ 90 ; min. 80% of luminous flux after 50000 operating hours; energy efficient LEDs with high CRI; good glare control through recessed light point level; precise radiation characteristic with 24° beam; no multiple shadows; optical attachment available as accessory; accessories are listed separately; degree of protection IP20; PC3; DALI-2 control; flicker-free visual comfort through analogue current control (minimum value 1%); light source replaceable by an authorized professional;

Light distribution

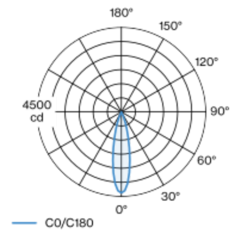

medium 24°		
h (m)	EO° (lx)	ø (m)
1	4310	0.42
2	1080	0.83
3	480	1.25
4	270	1.67
5	170	2.09

Product drawing

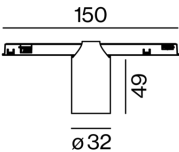

General

Ceiling / Wall , Track

chrome

IP20

811 lm

LED

3000 K

CRI ≥ 90

L80 / 50000 h

initial MacAdam ≤ 2 SDCM

R_g: 100 , R_f: 91 , R_{f(1-5)}: 88

MR 0.59

MDER 0.53

Optical

medium

beam angle 24°

PstLM ≤ 1.0 ¹

SVM ≤ 0.4 ¹

Electrical

DALI-2

system 9.6 W

PC3

system 84 lm/W²

1 DALI Addr.

Physical

diameter 32 mm

height 60 mm

¹ Value of containing product at full load (undimmed)

² incl. optical losses and the efficiency of the operating device (converter)

Installation instructions

