

TARO 32 downlight

MOVE IT 10 round
030-6740636M



Project / Type _____

Notes _____

Count / Date _____



General

Ceiling / Wall , Track _____

brushed aluminium _____

IP20 _____

859 lm _____

optical inset 99 lm/W¹ _____

LED

4000 K _____

CRI ≥ 90 _____

L80 / 50000 h _____

initial MacAdam ≤ 2 SDCM _____

R_g: 97 , R_f: 90 , R₍₁₋₁₅₎: 89 _____

MR 0.81 _____

MDER 0.74 _____

Optical

medium _____

beam angle 24° _____

PstLM ≤ 1.0 ² _____

SVM ≤ 0.4 ² _____

Electrical

DALI-2 _____

48 V _____

fixture 9.6 W _____

fixture 89 lm/W³ _____

optical inset 8.7 W _____

PC3 _____

1 DALI Addr. _____

Physical

diameter 32 mm _____

height 60 mm _____

Cylindrical spotlight in aluminium; surface lacquered in brushed aluminium; light inset can be installed and moved without tools by means of clip mount; power supplied via MOVE IT system track profile; hot plug protection; passive cooling of the LEDs through improved heat sink geometry; light colour 4000 K; binning initial MacAdam ≤ 2 SDCM; CRI ≥ 90; min. 80% of luminous flux after 50000 operating hours; energy efficient LEDs with high CRI; good glare control through recessed light point level; precise radiation characteristic with 24° beam; no multiple shadows; optical attachment available as accessory; accessories are listed separately; degree of protection IP20; PC3; 48 V; DALI-2 control; flicker-free visual comfort through analogue current control (minimum value 1%); light source replaceable by an authorized professional;

Light distribution



medium 24°			
h (m)	EO° (lx)	ø (m)	
1	4570	0.42	
2	1140	0.83	
3	510	1.25	
4	290	1.67	
5	180	2.09	

Product drawing

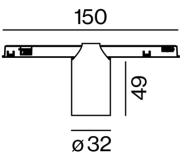

Installation instructions

