

# TARO 32 downlight

MOVE IT 10 round  
030-6740638M



Project / Type \_\_\_\_\_

Notes \_\_\_\_\_

Count / Date \_\_\_\_\_



### General

Ceiling / Wall , Track \_\_\_\_\_

jet black , RAL 9005 <sup>1</sup> \_\_\_\_\_

IP20 \_\_\_\_\_

859 lm \_\_\_\_\_

optical inset 99 lm/W<sup>2</sup> \_\_\_\_\_

### LED

4000 K \_\_\_\_\_

CRI ≥ 90 \_\_\_\_\_

L80 / 50000 h \_\_\_\_\_

initial MacAdam ≤ 2 SDCM \_\_\_\_\_

R<sub>g</sub>: 97 , R<sub>f</sub>: 90 , R<sub>(1-15)</sub>: 89 \_\_\_\_\_

MR 0.81 \_\_\_\_\_

MDER 0.74 \_\_\_\_\_

### Optical

medium \_\_\_\_\_

beam angle 24° \_\_\_\_\_

PstLM ≤ 1.0 <sup>3</sup> \_\_\_\_\_

SVM ≤ 0.4 <sup>3</sup> \_\_\_\_\_

### Electrical

DALI-2 \_\_\_\_\_

48 V \_\_\_\_\_

fixture 9.6 W \_\_\_\_\_

optical inset 8.7 W \_\_\_\_\_

PC3 \_\_\_\_\_

1 DALI Addr. \_\_\_\_\_

### Physical

diameter 32 mm \_\_\_\_\_

height 60 mm \_\_\_\_\_

### Light distribution

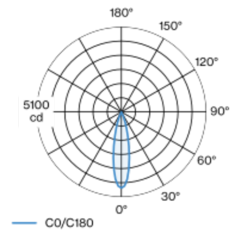

medium 24°

h (m)	EO° (lx)	ø (m)
1	4570	0.42
2	1140	0.83
3	510	1.25
4	290	1.67
5	180	2.09

### Product drawing

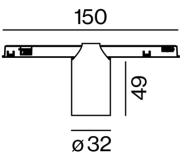

<sup>1</sup> RAL code

<sup>2</sup> OPTICAL INSET: incl. consideration of optical losses

<sup>3</sup> Value of containing product at full load (undimmed)

### Installation instructions



# TARO 32 downlight

MOVE IT 10 round  
030-6740638M



Project / Type

Notes

Count / Date

## Maintenance Factors

Operating Time [h]	10 000	20 000	30 000	40 000	50 000
LLMF	0.96	0.92	0.89	0.85	0.82
LSF	1	1	1	1	1

MF

MF

LMF<sup>a</sup>

LMF × RSMF × LLMF × LSF

Maintenance Factor

Luminaire Maintenance Factor

RSMF<sup>a</sup>

LLMF

LSF

Room Surface Maintenance Factor

Lamp Lumens Maintenance Factor

Lamp Survival Faktor

<sup>a</sup> According to "CIE 97, Maintenance of indoor electric lighting systems", 2005, ISBN 3-900-734-34-8. The values must be determined by the planner.

## Optical accessories

### HONEYCOMB LOUVER

COLOUR	Ø (MM)	ARTICLE NUMBER(S)
jet black	30	007-1965168



## Optical accessories

### OVAL LENS

Ø (MM)	ARTICLE NUMBER(S)
30	007-1965860



### SOFT LENS

Ø (MM)	ARTICLE NUMBER(S)
30	007-1965960



### WALLWASHER LENS

Ø (MM)	ARTICLE NUMBER(S)
30	007-1965760

