

TASK

circle direct / indirect

power

suspended

059-5281137K



Project / Type

Notes

Count / Date

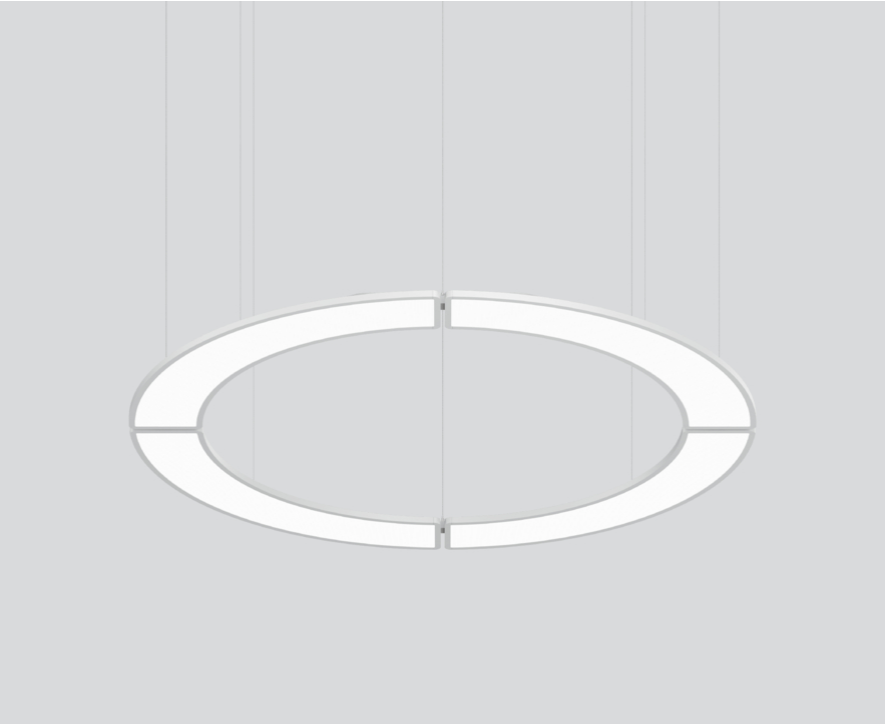

General
Ceiling , Suspended
white , RAL 9010 ¹
IP20
indirect 6870 lm
direct 13200 lm
total 20100 lm

LED
4000 K
CRI ≥ 90
L90 / 50000 h
initial MacAdam ≤ 3 SDCM
R _g : 96 , R _f : 90 , R _{t(1-15)} : 87
MR 0.75
MDER 0.68

Optical
Microprismatic
microprismatic
UGR < 19
PstLM ≤ 1.0 ²
SVM ≤ 0.4 ²

Electrical
DALI-2
220-240 V
system 169 W
system 119 lm/W ³
PC1
4 DALI Addr.

Physical
cable 1500 mm
diameter 1535 mm
height 36 mm
14.1 kg

Ring-shaped suspended luminaire, consisting of single elements in quarter circle shape; luminaire housing with rounded edges in aluminium; extremely flat design (only 15mm); modern shape in elegant design for discerning requirements; surface white powder coated; luminaire with 1500 mm cable suspension; with integrated toolless suspension height adjustment on the luminaire; incl. feed (white); direct light distribution through LGP body (Light Guiding Prism); side coupled light directed downwards by laser engraving; light control via highly reflective reflector material; indirect light component with special PCBs for increased luminous flux and maximum ceiling illumination; microprismatic PMMA cover; completely homogeneous illumination; UGR ≤ 19; light colour 4000 K; binning initial MacAdam ≤ 3 SDCM; CRI ≥ 90; min. 90% of luminous flux after 50000 operating hours; energy efficient LEDs with high CRI; canopy with 2 cable openings and plug-in terminal for through wiring; degree of protection IP20; PC1; 220-240 V; internal wiring in light halogen free; incl. DALI-2 converter; light source replaceable by an authorized professional; control gear replaceable by an authorized professional;

Light distribution

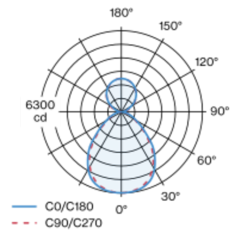

Product drawing

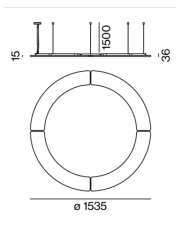

¹ RAL code ² Value of containing product at full load (undimmed)
³ FIXTURE: incl. consideration of optical losses & internal control unit losses SYSTEM: incl. consideration of optical losses, internal control unit losses & operating device efficiency.

Installation instructions



Lighting calculator



TASK circle direct / indirect power

suspended

059-5281137K



Project / Type

Notes

Count / Date

Maintenance Factors

Operating Time [h]	10 000	20 000	30 000	40 000	50 000
LLMF	0.98	0.97	0.95	0.93	0.92
LSF	1	1	1	1	1
MF	LMF × RSMF × LLMF × LSF		RSMF ^a Room Surface Maintenance Factor		
MF	Maintenance Factor		LLMF Lamp Lumens Maintenance Factor		
LMF ^a	Luminaire Maintenance Factor		LSF Lamp Survival Faktor		

^a According to "CIE 97, Maintenance of indoor electric lighting systems", 2005, ISBN 3-900-734-34-8. The values must be determined by the planner.

Circuit Breaker Types

Automatic Circuit Breaker Type	Number of Fixtures
B10	2
B13	3
B16	3
B20	4
C10	3
C13	5
C16	6
C20	7

Acoustic accessories

TASK ACOUSTIC inlay TASK circle suspended

COLOUR	L-W-H (MM)	ARTICLE NUMBER(S)
marble grey	1155-1155-30	059-579736D
felt grey	1155-1155-30	059-579736G
black	1155-1155-30	059-579736L
white	1155-1155-30	059-579736W
acoustic special colours	1155-1155-30	059-579736X

TASK ACOUSTIC inlay TASK long circle suspended

COLOUR	L-W-H (MM)	ARTICLE NUMBER(S)
marble grey	1155-2346-30	059-579738D
felt grey	1155-2346-30	059-579738G
black	1155-2346-30	059-579738L
white	1155-2346-30	059-579738W
acoustic special colours	1155-2346-30	059-579738X

